



**PIPE EQUIPMENT SPECIALISTS**

# PREP 16 PIPE BEVELLING 3" to 16"



SCAN QR CODE  
TO WATCH VIDEO



**TAG** **PREP 16**  
*Portable Pipe Beveling Machine*

**RANGE: 72 - 400mm i/d / 2.8 - 15.74" i/d**

- **Functions:** External beveling  
Internal beveling  
Facing  
Counter-boring  
Weld removal  
J-prepping  
Compound bevels
- **Materials:** Any kind of steel and exotic alloy
- **Power:** Servo electric (Recommended), pneumatic or hydraulic



**FEATURES AND ADVANTAGES**

The PREP 16 is the first in TAG's new range of a heavy duty mid-large diameter beveling machines.

Offering ratcheted i/d jaw locking as well as ratchet bevel feed control for effortless heavy wall preps, offered with an extremely powerful and user friendly servo electric or pneumatic motor. Any bevel geometry can be performed within the impressive 3" - 16" range.

J-preps, counter boring, and facing can all be performed, simultaneously, using the correct tooling fitted in (up to) 4 heavy duty hardened multi-position tool holders. Due to its light weight, yet unrivalled power, the PREP 16 is ideal for on-site, off shore, nuclear, and other applications where precision welds are required at an incredible value.

The PREP 16, and its bigger brother the PREP 24, utilise ratchet feed and locking. This allows effortless set-up, and enables the operator to deliver consistent feed with minimal effort.



**POWER OPTIONS:**

**SERVO ELECTRIC**

**RECOMMENDED**



**PART NO. TP16SE110 / TP16SE220**

**PNEUMATIC**



**PART NO. TP16P**

**HYDRAULIC**



**PART NO. TP16H**

# FEATURES:

## SELF-CENTERING

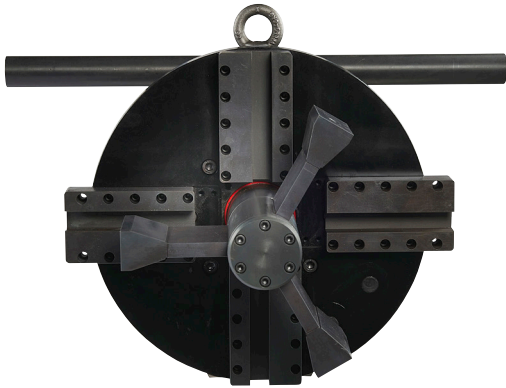

Self-centering 70mm (2.75") one piece locking shaft with built in jaws, eliminates the issue of broken or loosening retaining springs and o-rings.

## UNRIVALLED POWER AND STABILITY



TAG innovative bearing/crown and pinion design combined with our large shaft, delivers unrivalled power and stability.

## SERVO ELECTRIC



**RECOMMENDED**

**PATENT  
PENDING**

SERVO ELECTRIC control box makes the strongest portable pipe beveling machine available on the market.

## LIFTING HANDLES



To enable ease of set up, the machine is equipped with lifting handles and removable extensions so the machine can be easily installed, and removed from the pipe.

## RATCHET FEED AND LOCKING



The PREP 16 has unrivalled power and stability, utilising a ratchet system for both jaw locking, and bevel feed.

## SIX POINT LOCKING



Innovative wide locking jaws offer 6 point locking from 3 jaws giving superior clamping force for chatter free end preps.

## PREP 16 TECHNICAL FEATURES

| DESCRIPTION                  | MEASUREMENT     | PNEUMATIC               | SERVO ELECTRIC          | HYDRAULIC                     |
|------------------------------|-----------------|-------------------------|-------------------------|-------------------------------|
| Part Number                  | n/a             | TP16P                   | TP16SE110 / TP16SE220   | TP16H                         |
| Locking tube range           | mm / inch (i/d) | 72 - 400 / 2.8 - 15.74" | 72 - 400 / 2.8 - 15.74" | 72 - 400 / 2.8 - 15.74"       |
| Working range                | mm / inch (o/d) | 72 - 406 / 3 - 16"      | 72 - 406 / 3 - 16"      | 72 - 406 / 3 - 16"            |
| Idle speed                   | rpm             | 5 - 18                  | 1 - 18                  | 1 - 26                        |
| Length of axial feed         | mm / inch       | 50 / 2                  | 50 / 2                  | 50 / 2                        |
| Max operating temperature    | °C              | 55                      | 60                      | 60                            |
| Max acoustic radiation       | dB              | 75                      | 45                      | 55                            |
| Pneumatic Motor Power        | hp              | 3.5                     | n/a                     | 5.4                           |
| Air Consuming Flux           | cfm / l/min.    | 90 / 2500               | n/a                     | n/a                           |
| Air working pressure         | psi / bar       | 90 / 6.5                | n/a                     | n/a                           |
| Air Hose Connection          | inches          | ¾"                      | n/a                     | n/a                           |
| Servo Electric Motor Power   | kw              | n/a                     | 1.5                     | n/a                           |
| Voltage                      | volt            | n/a                     | 110 or 220              | refer to hydraulic power pack |
| Frequency                    | Hz              | n/a                     | 50 / 60                 | refer to hydraulic power pack |
| Remote Control               | Yes / No        | No                      | Yes                     | Yes                           |
| Forward / Reverse            | Yes / No        | No                      | Yes                     | Yes                           |
| Unit weight                  | kg / lbs        | 43 / 95                 | 44 / 97                 | 41 / 90                       |
| Packing dimensions L x W x H | mm              | 860 x 570 x 530         | 860 x 570 x 530         | 860 x 570 x 530               |
| Packing weight               | kg / lbs        | 128 / 282               | 140 / 305               | 125 / 275                     |

*Our group policy is one of continuous improvement. Products and data tables are subject to change or vary from those illustrated.*

- All units are supplied complete with all locking jaws to cover the full range of the machine. Service tools, drawings, instruction manual and warranty certificate are also supplied as standard.
- Each machine is supplied with a protective custom built box.
- Pneumatic machine must be used with filter lubricator and oil - use without will void warranty.

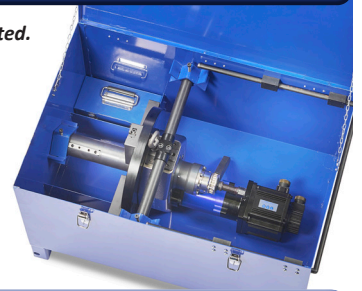

### DIMENSIONS

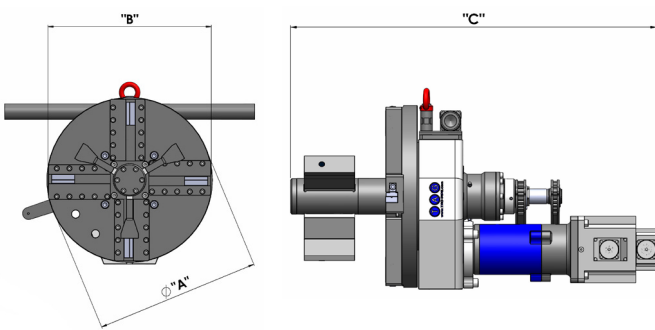

| DIMENSIONS |    | PNEUMATIC | SERVO ELECTRIC | HYDRAULIC |
|------------|----|-----------|----------------|-----------|
| ØA         | mm | 323       | 323            | 323       |
| B          | mm | 407       | 407            | 407       |
| C          | mm | 750       | 630            | 530       |

### EXAMPLES OF COMMON CUTTING TOOLS

#### FORMED TOOLS

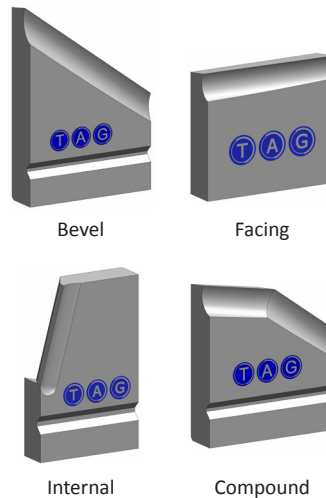

#### HOLDER / INSERT (Recommended)

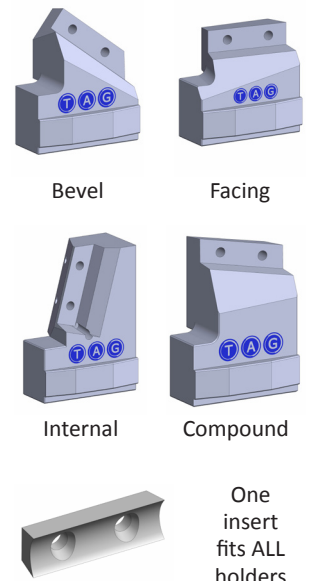

All shapes, sizes and angles available



# PREP 16 AND PREP 24 ELBOW / FITTINGS

*Portable Elbow and Fitting Machine*

The TAG PREP 16 ELBOW / FITTINGS and TAG PREP 24 ELBOW / FITTINGS complete machine enables bevelling, J-preps, counter boring and facing on elbows and pipe fittings, due to its heavy duty yet compact shaft and 6 piece locking jaw system. The machines can be supplied with either servo electric, pneumatic or hydraulic motor.

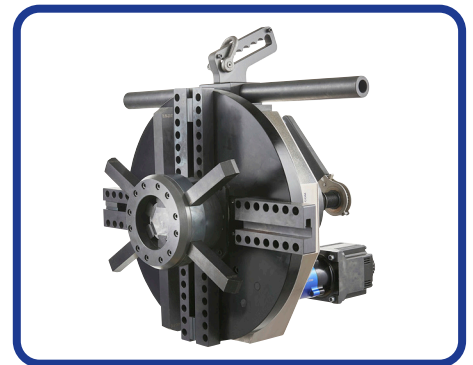
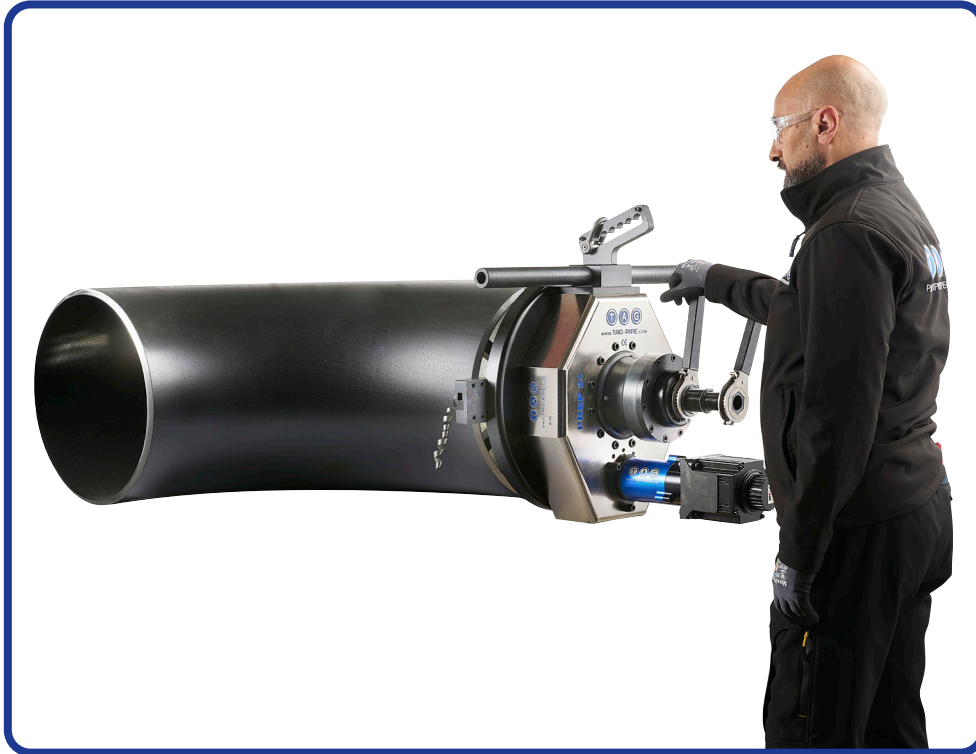

## PREP 16 AND PREP 24 ELBOW / FITTINGS TECHNICAL FEATURES

| DESCRIPTION        | MEASUREMENT     | PNEUMATIC                   | SERVO ELECTRIC              | HYDRAULIC                   |
|--------------------|-----------------|-----------------------------|-----------------------------|-----------------------------|
| Part Number        | n/a             | TP16EP                      | TP16ESE110 / TP16ESE220     | TP16EH                      |
| Locking tube range | mm / inch (i/d) | 130 - 410mm / 5.11 - 16.14" | 130 - 410mm / 5.11 - 16.14" | 130 - 410mm / 5.11 - 16.14" |
| Part Number        | n/a             | TP24EP                      | TP24ESE110 / TP24ESE220     | TP24EH                      |
| Locking tube range | mm / inch (i/d) | 210 - 600mm / 8.26 - 23.62" | 210 - 600mm / 8.26 - 23.62" | 210 - 600mm / 8.26 - 23.62" |

## DIMENSIONS PREP 16/24 ELBOW / FITTINGS

|         | DIMENSIONS |    | PNEUMATIC | SERVO ELECTRIC | HYDRAULIC |
|---------|------------|----|-----------|----------------|-----------|
| PREP 16 | ØA         | mm | 323       | 323            | 323       |
|         | B          | mm | 407       | 407            | 407       |
|         | C          | mm | 705       | 650            | 550       |
| PREP 24 | ØA         | mm | 550       | 550            | 550       |
|         | B          | mm | 580       | 580            | 580       |
|         | C          | mm | 755       | 705            | 605       |

## EXAMPLES OF FITTINGS

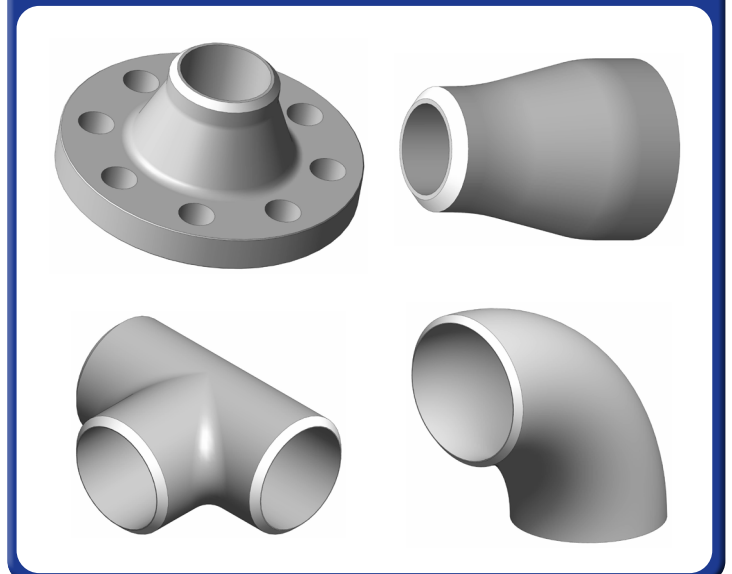



**SPECIALIZED FABRICATION EQUIPMENT GROUP**

## Global Locations:



### UNITED STATES HEAD OFFICE - HOUSTON

**SPECIALIZED FABRICATION EQUIPMENT GROUP**

4433 South Drive,  
Houston,  
Texas 77053, USA

Tel: +1 713 747 8502

E-mail: [sales@sfe-brands.com](mailto:sales@sfe-brands.com)

### INTERNATIONAL HEAD OFFICE - FRANCE

**SPECIALIZED FABRICATION EQUIPMENT GROUP**

330B Route de Portes Les Valence,  
ZI les Bosses,  
26800 Etoile-sur-Rhône, France

Tel: + 33 (0) 475 575 070

E-mail: [sales-int@sfe-brands.com](mailto:sales-int@sfe-brands.com)

#### SFE UNITED KINGDOM

**SPECIALIZED FABRICATION EQUIPMENT GROUP**

Unit 15 & 16 Grendon Industrial Estate,  
Grendon Underwood, Aylesbury,  
Buckinghamshire, HP18 0QX England

Tel: +44 (0)1869 324 144

E-mail: [sales-uk@sfe-brands.com](mailto:sales-uk@sfe-brands.com)

#### SFE GERMANY

**SPECIALIZED FABRICATION EQUIPMENT GROUP**

Ostmarkstrasse 15,  
76437 Rastatt,  
Germany

Tel: +49 (0)7222 9355100

E-mail: [sales-germany@sfe-brands.com](mailto:sales-germany@sfe-brands.com)

#### SFE KINGDOM OF SAUDI ARABIA

**SPECIALIZED FABRICATION EQUIPMENT GROUP**

Warehouse No: EM16-10, Air Base Determinant,  
Industrial supply scheme, Ash Shulah, Dammam  
34264, Saudi Arabia

Tel: + 966 50 515 8196

E-mail: [sales-ksa@sfe-brands.com](mailto:sales-ksa@sfe-brands.com)

#### SFE MIDDLE EAST

**SPECIALIZED FABRICATION EQUIPMENT GROUP**

Shams Freezone  
Sharjah

United Arab Emirates

Tel: +971 (0)50 217 1376

E-mail: [sales-me@sfe-brands.com](mailto:sales-me@sfe-brands.com)

#### SFE INDIA

**SPECIALIZED FABRICATION EQUIPMENT GROUP**

Plot No. PAP 3, D 3 Block,  
Chinchwad, Pune 411 019

Mob: +91 90 1102 4332

Mob: +91 95 5258 4361

E-mail: [sales-india@sfe-brands.com](mailto:sales-india@sfe-brands.com)

#### SFE LATIN AMERICA

**SPECIALIZED FABRICATION EQUIPMENT GROUP**

4433 South Drive,  
Houston,

Texas 77053, USA

Tel: +1 713 747 8502

E-mail: [sales-latam@sfe-brands.com](mailto:sales-latam@sfe-brands.com)

#### SFE SOUTH KOREA

**SPECIALIZED FABRICATION EQUIPMENT GROUP**

102 - 1301 Bucheon Technopark III  
421 - 742 Gyeonggi-do-seoul, Taehan-min'guk  
South Korea

Tel: +82 32 624 2870

E-mail: [sales-asia@sfe-brands.com](mailto:sales-asia@sfe-brands.com)

#### SFE VIETNAM

**SPECIALIZED FABRICATION EQUIPMENT GROUP**

Emerald Block A, No.2, Road N4,  
Son Ky Ward, Tan Phu District,  
Ho Chi Minh, Vietnam

Tel: +84 91 951 70 18

E-mail: [sales-vietnam@sfe-brands.com](mailto:sales-vietnam@sfe-brands.com)

#### SFE CHINA

**SPECIALIZED FABRICATION EQUIPMENT GROUP**

1208, 12F, #D 7001 Zhongchun RD  
Minhang District  
Shanghai, China

Tel: +86 215 429 1891

E-mail: [sales-china@sfe-brands.com](mailto:sales-china@sfe-brands.com)

Copyright © 2022 Specialized Fabrication Equipment Group, All rights reserved.

## OUR BRANDS

